

City of Haslet Public Hearing Notice

The City of Haslet, Texas, proposes to annex for the purpose of enlarging and extending its boundary limits so as to include approximately 3.473 acres of land hereinafter described as:

An approximate 3.473 acre parcel of land located along the northwest side of Blue Mound Road East, east of FM 156, being Lot 1, Blue Mound Estates, an addition out of the S.M. Wilson, E. Hopkins and G.M. Lewis surveys in Tarrant County, Texas according to the plat recorded in Volume 388-37, Page 24, Plat Records, Tarrant County, Texas, and commonly known as 415 Blue Mound Road East, Haslet, Texas.

and as depicted on the map viewable on the City's web site (www.haslet.org) on or after June 30, 2015. Copies of the map of the area proposed for annexation will also be available at Haslet City Hall, 101 Main Street, Haslet, Texas 76052

The Haslet City Council will conduct a Public Hearing on the proposed annexation on July 20, 2015 at 7:00 pm, at the Haslet Community Center, 105 Main Street, Haslet, Texas 76052, for all persons interested in the above-proposed annexation. At said time and place, all persons shall have the right to appear and be heard. Of all said matters and things, all persons interested in the things and matters herein mentioned will take notice.

Dated this 30th day of June, 2015

Dianna Buchanan, City Secretary



City of Haslet
101 Main St.
Haslet, TX 76052
www.haslet.org
(817) 439-5931

Parkland Annexation

Area to be Annexed:
Lot 1 Blue Mound Estates Subdivision

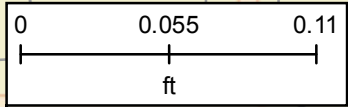
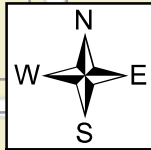
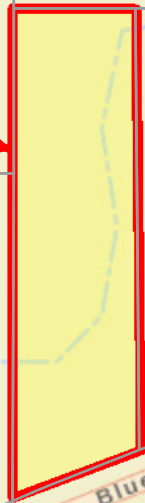
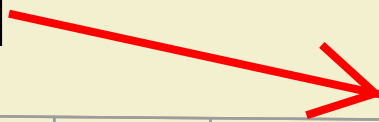

Sources: Esri, HERE, DeLorme, USGS, Intermap, increment P Corp., NRCAN, Esri Japan, METI, Esri China (Hong Kong), Esri (Thailand), TomTom, MapmyIndia, © OpenStreetMap contributors, and the GIS User Community

Legend

- Parcels
- Override 1