

ASPHALT DRIVEWAY REPAIR DETAIL
N.T.S.

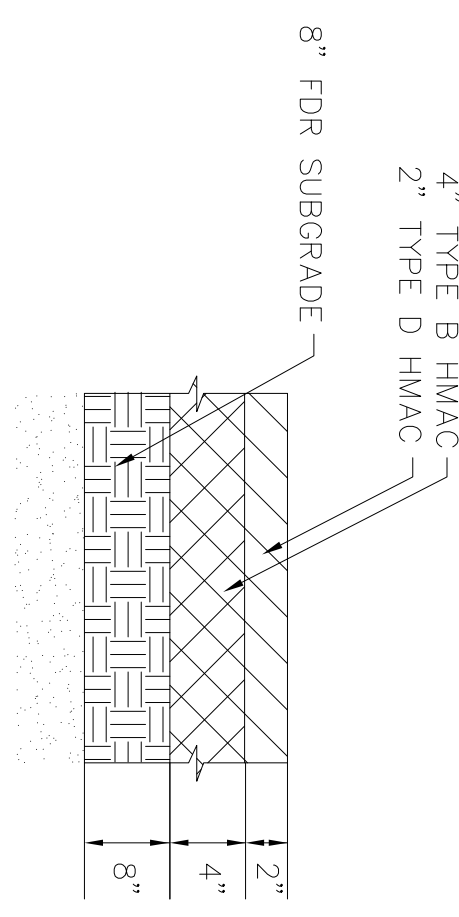

PERMANENT ASPHALT TRANSITION

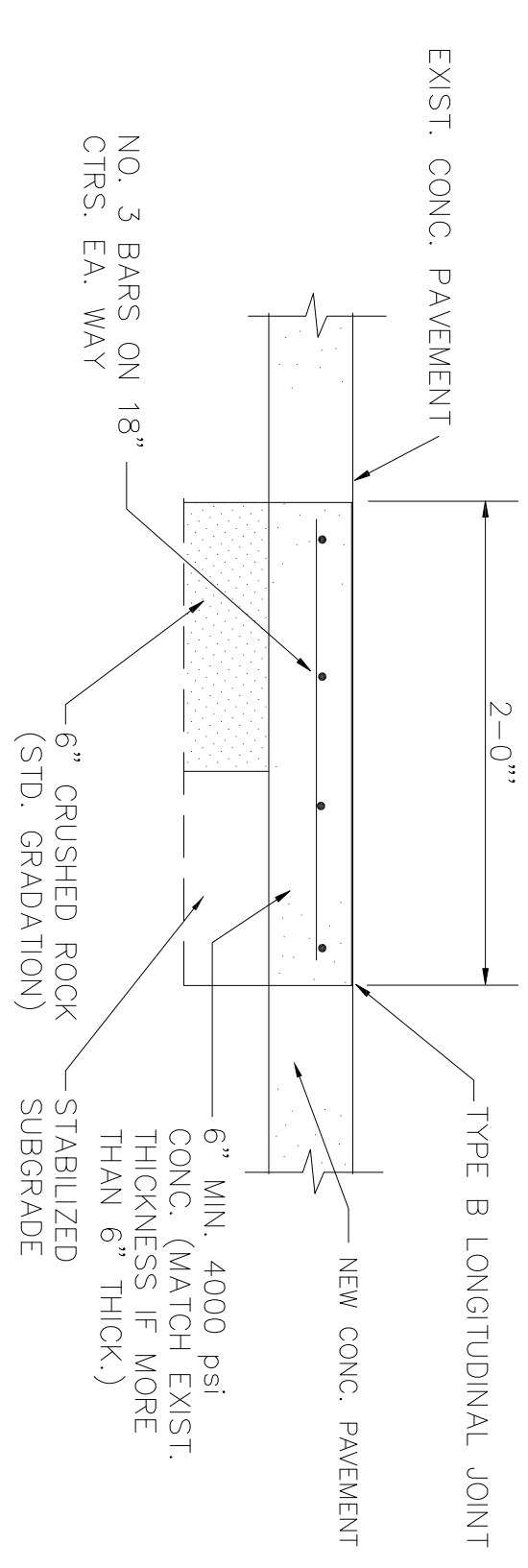

CONCRETE DRIVEWAY REPAIR
N.T.S.

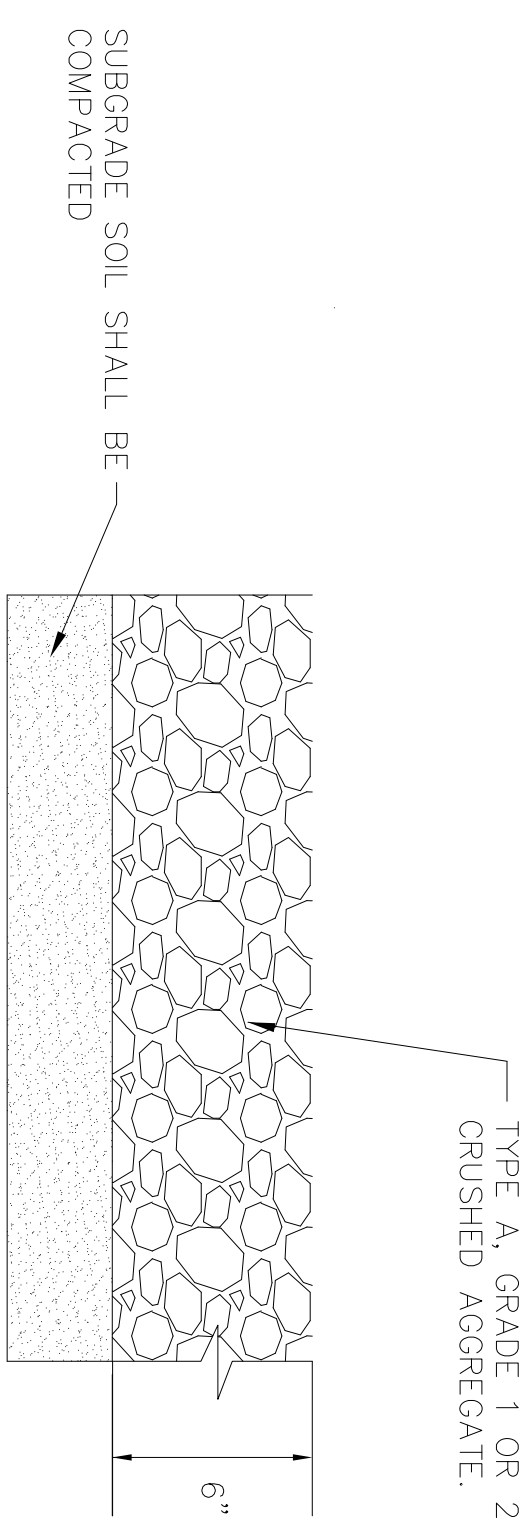

GRAVEL DRIVEWAY REPAIR
N.T.S.

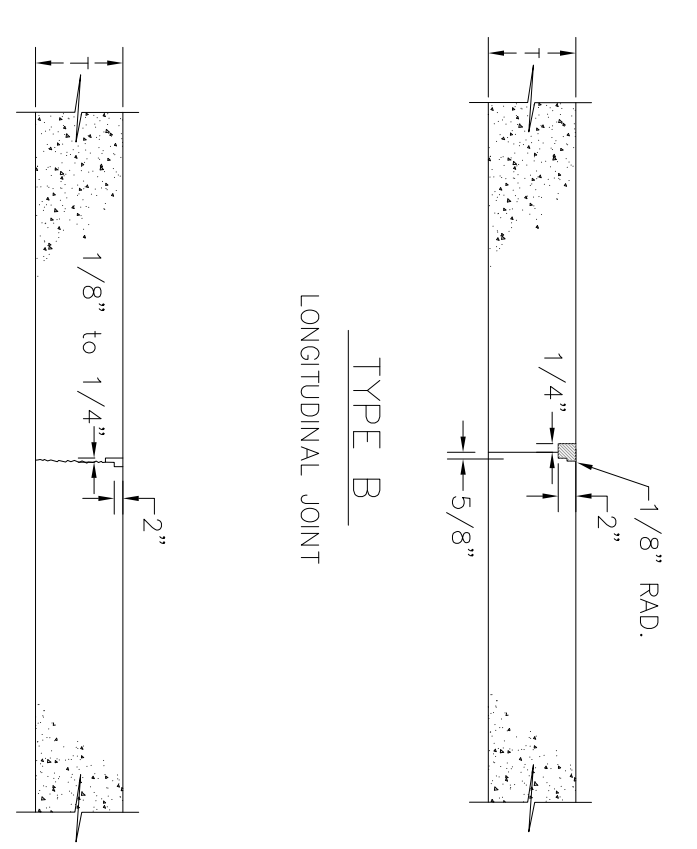

RCC PAVEMENT JOINTS
NOT TO SCALE

- GENERAL NOTES**
1. ALL REINFORCING STEEL SHALL BE DEFORMED BARS. REINFORCING STEEL SHALL BE PLACED WITH THE CENTER OF THE OUTSIDE LAYER OF BARS 2" FROM THE SURFACE OF THE CONCRETE.
 2. WHERE REINFORCING BARS ARE SPICED, A 30 DIAMETER LAP SHALL BE USED.
 3. TYPE C TRANSVERSE CONTRACTION JOINTS SHALL BE ON 15' CENTERS.
 4. AN APPROVED WHITE PIGMENTED CURING COMPOUND SHALL BE APPLIED TO THE SURFACE OF THE CONCRETE AS SOON AS IT HAS BEEN Poured AND FINISHED.
 5. ALL SAWED JOINTS SHALL BE COMPLETED WITHIN 5-12 HOURS AFTER CONCRETE HAS BEEN PLACED.
 6. THE CONCRETE USED FOR ALL STREET PAVING SHALL BE CLASS "C" WITH A MINIMUM OF FIVE (5) SACKS OF CEMENT PER CUBIC YARD OF CONCRETE AND A 4000 P.S.I. MIN. @ 28 DAYS.



101 MAIN STREET
HASLETT, TX 76052
(817)439-5931
WWW.HASLETT.ORG



Know what's below.
Call before you dig.
@least 48 hours prior

**CITY OF HASLET
CONSTRUCTION STANDARDS**
**PAVING DETAILS
ROLLER COMPACTED CONCRETE STREETS**

CERTIFICATION:
THIS CITY OF HASLET SHEETS
AUTHORIZED FOR USE ON THIS
PROJECT BY AUTHORITY OF THE CITY
ENGINEER AND THE CITY ENGINEER
IN THE CONSTRUCTION SET OF SHEET
DRAWINGS. THE ENGINEER OF
RECORD FOR THE PROJECT IS ALSO
RESPONSIBLE FOR THE SHEET AND
THE DETAILS AND NOTES HAVE NOT
BEEN ALTERED FROM THAT RECEIVED
FROM THE CITY OF HASLET.

DRAWN: CAD
APPROVED: TNA
DATE: MAR 2018
SHEET NUMBER

P6